

# flyte™

Comfy as Home.  
Portable as Your Pillow.  
Unfold and Inflate.  
Dream Anywhere.

## Instruction Manual

Flyte™ Vento Series Air Bed with Built-in Electric Pump

For Twin and Queen Bed



ML





# Comfy as Home, Portable as Your Pillow: Unfold, Inflate, Dream Anywhere.

Experience the ultimate in convenience without compromising on comfort. With our quick-inflate electric pump, you can go from box to bed in minutes, ensuring you're always ready for a good night's sleep, wherever life takes you. Durable, dependable, and delightfully cozy – that's the promise of our portable beds. Sleep well, anywhere, anytime.



ELECTRIC PUMP INFLATION IN MINUTES



LIGHTWEIGHT



EASY TO USE



FLOCK TOP TO HOLD BEDDING



SOFT VELVET FEEL AND COMFORT



203cm (L) x 152cm (W) x 45cm (H)



191cm (L) x 99cm (W) x 45cm (H)



Excellent comfort with  
Heavy-duty vinyl wave beam  
construction





Flock top prevents sheets from slipping, providing 'soft velvet' feel and comfort



Storage bag and patch repair kit included



45cm (H)

45cm Height for a better night's sleep and ease in getting up



Built in AC Pump inflates, <3 Minutes (Twin), < 6 minutes (Queen)

flyte



## 1. Warnings & Precautions

- The maximum working Air pressure of this pump is less than 0.5bar.
  - This is a high-volume low-pressure pump. It is intended to inflate/deflate items, such as inflatable beds etc.
  - Power supply: Input AC220-240V
  - Do not allow any child to operate this electric pump.
  - Make sure that there is no debris at the outlet and inlet in use.
  - Store this product in a dry place.
  - A child may be pinched between the air mattress and any adjacent vertical surface.
  - There should be a space with at least one shoulder width between the air mattress and the wall, dressing table or other vertical object, to avoid pinching.
  - Disposal: Do not dispose of this product as unsorted municipal waste. The waste must be collected separately for special disposal.
  - Make sure that the pressure in the air mattress is always enough in use.
  - If the power cord is damaged, it must be replaced by the manufacturer after-sale service personnel or professional personnel, to avoid any possible injury.
  - Do not operate continuously this pump. A long-period operation may cause a fault or overheating. The continuous operation period of this pump should not exceed 4-min (twin) 6-min (Queen).  
To avoid this pump overheating, must allow this pump to rest for 30-min between two full inflating cycles. Do not exceed 4 mins inflation for Twin and 6 mins inflation for Queen.
  - This appliance is not intended for use by persons (including children) with reduced physical, sensory or mental capabilities, or lack of experience and knowledge, unless they have been given supervision or instruction concerning use of the appliance by a person responsible for their safety.
- Children should be supervised to ensure that they do not play with the appliance.





## 2. Maintenance & storage

- Disconnect the power supply before moving, maintaining or adjusting this product.
- Fully cool and properly store this product if it is not used.
- Store this product in a dry and ventilated place.
- Clean the outer surface of this pump with a cloth immersed with mild soap/detergent and water.

## 3. Troubleshooting

Fault	Check	Solution
The electric pump cannot be started normally	<ol style="list-style-type: none"><li>1. The power supply is not installed properly</li><li>2. The motor is overheated or overloaded, resulting in the motor stop.</li></ol>	<ol style="list-style-type: none"><li>1. Make sure the plug is connected into the power outlet</li><li>2. Cool down and then restart the motor</li><li>3. If the fault can not be solved, please contact your local service agent or similar authorised personnel for replacement.</li></ol>

## 4. User instructions

### 1. Unpacking and Preparation:

1.1. Lay out the air bed in the intended area.

1.2. Ensure the area is free from sharp objects that could damage the bed.

### 2. Inflation:

2.1. Locate the built-in pump. It's on one end of the bed (fig 1).

FIG. 1

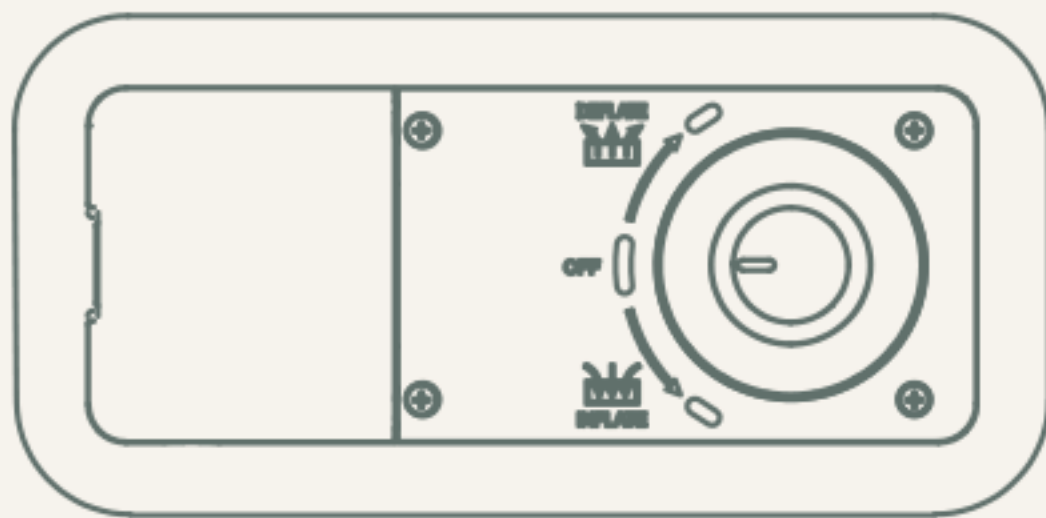

2.2. Open up the hatch and connect the pump to a power source (fig 2).

FIG. 2

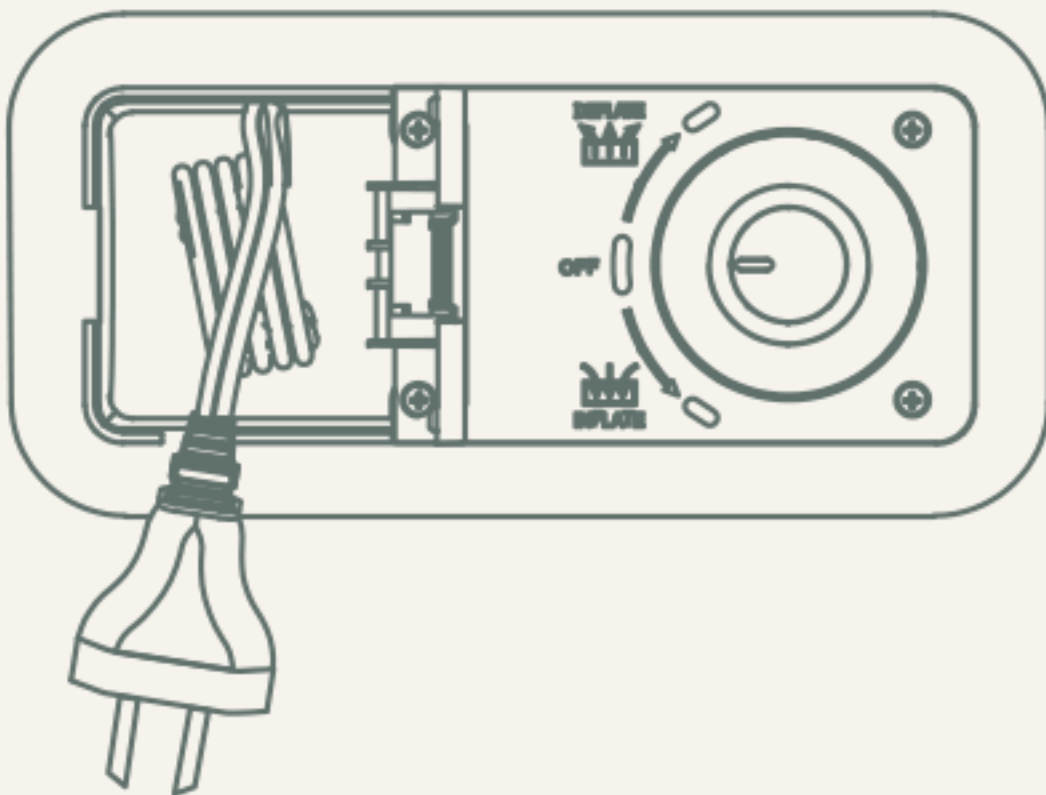

2.3 Make sure the pump is set to 'OFF' (fig 3).

FIG. 3

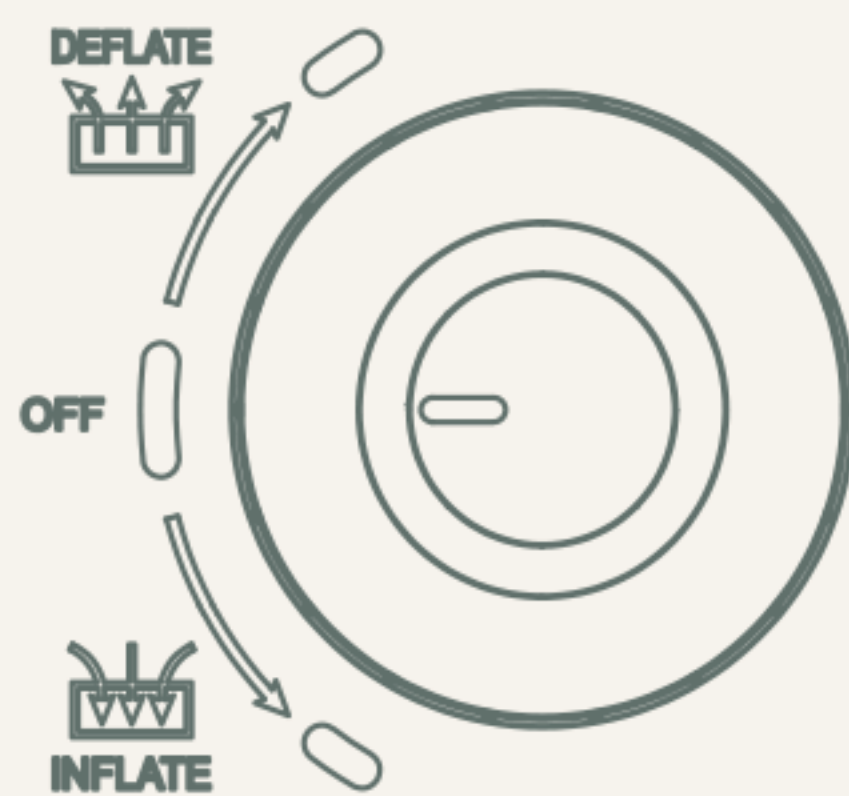

2.4. Turn on the pump. The bed will begin to inflate. It will take 3 mins for Twin and 5 mins for Queen (fig 4).

FIG. 4

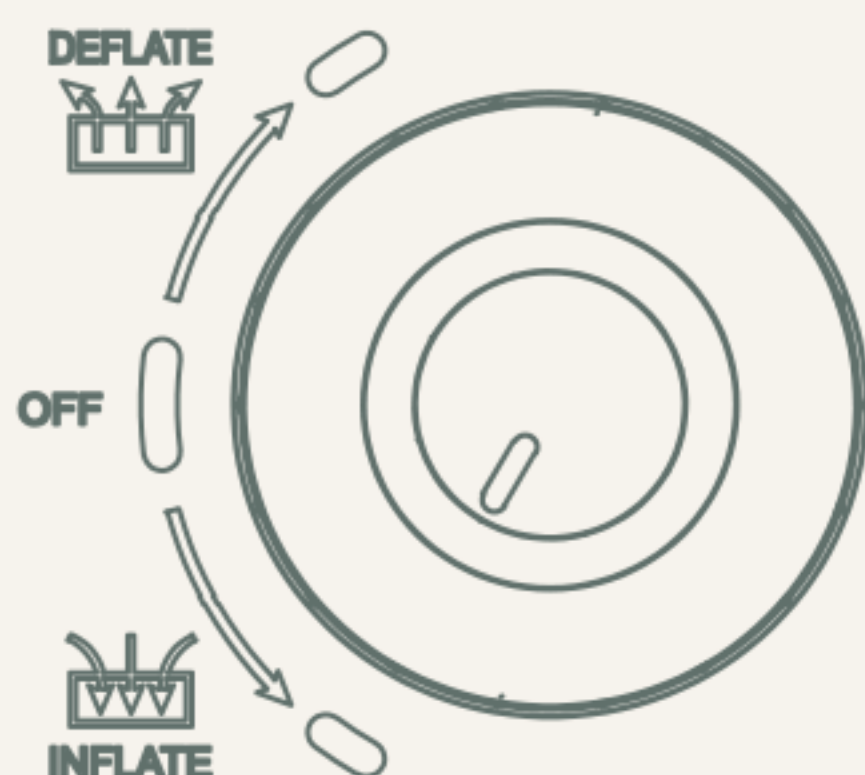

2.5. Monitor the inflation process. Turn off the pump when the bed reaches your desired firmness (fig 3). Be careful to not inflate for longer than 4 minutes (Twin) and 6 minutes (Queen).

### 3. Usage:

3.1. Once inflated, you can place bedding on the air bed as desired.

### 4. Deflation and Storage:

4.1. To deflate, open the valve and allow air to escape. For quicker deflation, you can turn the pump to the deflation setting (fig 5).

4.2. Gently fold or roll the bed, avoiding sharp folds to prevent damage and store the bed in a cool, dry place away from direct sunlight.

FIG. 5

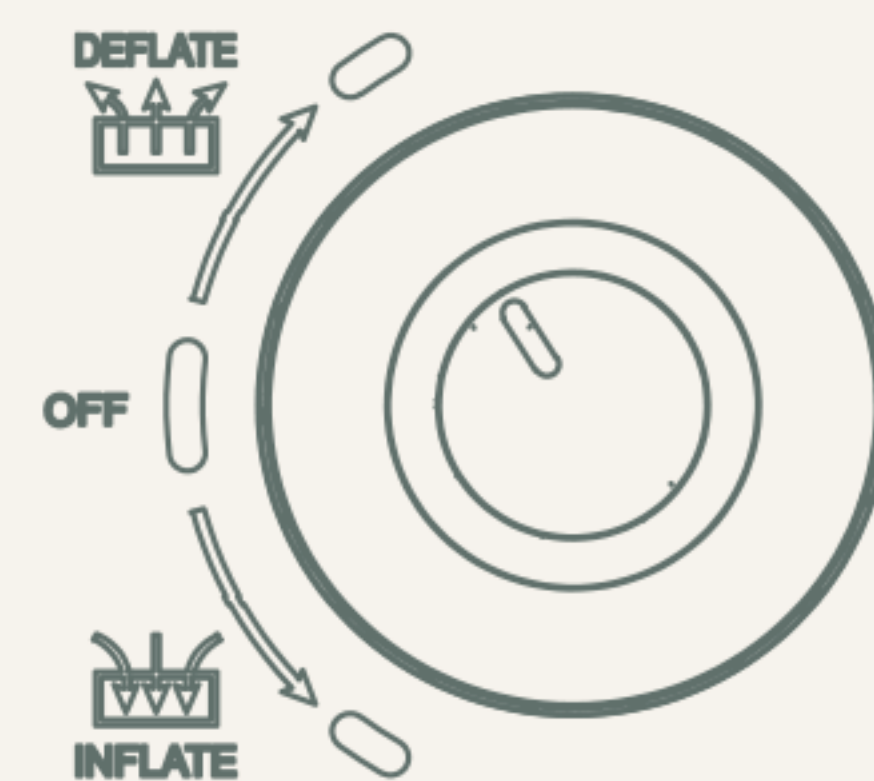

### 5. Safety and Maintenance

5.1. Regularly check for leaks or damages.

5.2. Avoid over-inflation as it can damage the bed.



## 5. How to fold

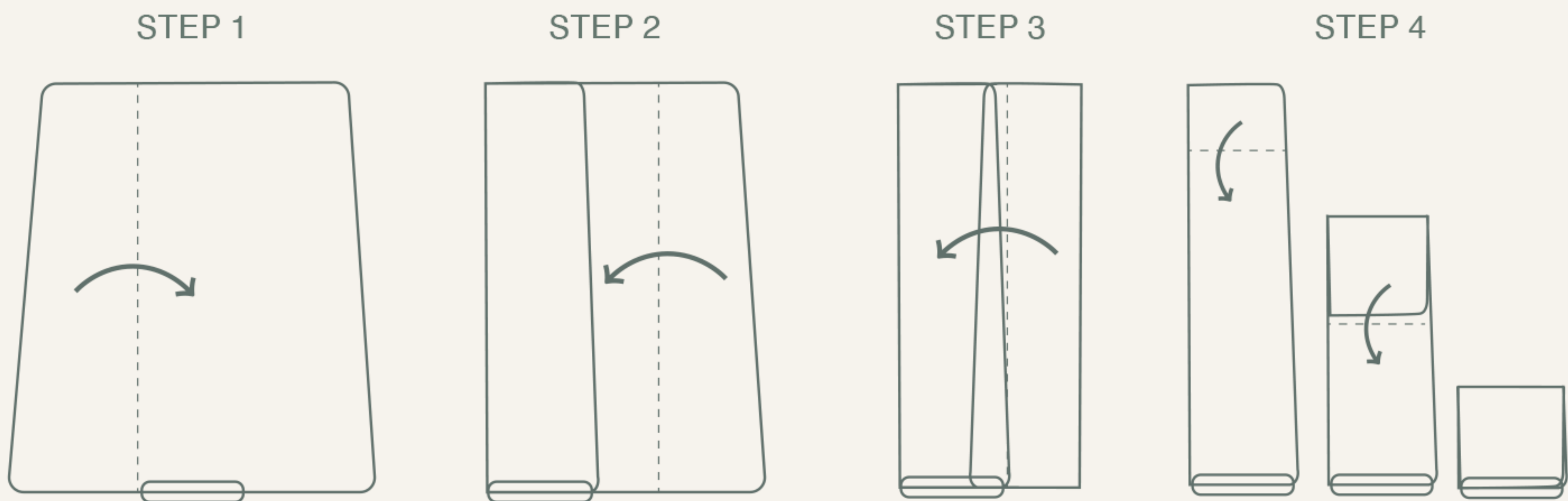

## 6. Cleaning

1. **Keep your mattress inflated:** This makes it easier to clean.
2. **Remove Debris:** If the mattress has visible dirt or debris, gently vacuum it off. This step is especially important if the mattress has been in storage or used outdoors.
3. **Prepare Cleaning Solution:** Mix a small amount of mild detergent or dish soap with warm water. aim for a lightly sudsy solution.
4. **Clean the Surface:** Dip a clean cloth or sponge in the soapy water, wring out excess liquid, and wipe down the mattress. Pay special attention to any spots or stains. For tougher stains, use a soft brush to gently scrub.
5. **Rinse Thoroughly:** After cleaning, use a second cloth dampened with plain water to rinse off any soap residue.
6. **Odour Treatment (Optional):** For any lingering odours, sprinkle baking soda over the mattress, let it sit for a few hours or overnight, then vacuum it up.
7. **Dry the Mattress:** Ensure the mattress is completely dry before storage or use. Air dry in a well-ventilated area or use a hair dryer on a cool setting. Avoid direct heat or sunlight.
8. **Check for Damage:** Inspect the mattress for any damage, such as tears or holes, during cleaning.
9. **Store Appropriately:** Once clean and dry, fold the mattress and store it in a cool, dry place. Use a storage bag if available.

Regular cleaning will help maintain your air mattress in good condition, ensuring it's always ready for use.





Comfy as Home.  
 Portable as Your Pillow.  
 Unfold and Inflate.  
 Dream Anywhere.

# Instruction Manual

## Flyte™ Vento Series Air Bed with Built-in Electric Pump

For Twin and Queen bed



**WARNING**  
 This airbed is not for use in water. IT IS NOT A LIFE SAVING DEVICE. It is not a personal flotation device or water toy.  
**IT IS NOT A TOY.** Do not stand, walk, jump or play on the airbed. This can result in damage or serious injury to the airbed and your health.  
**IMPORTANT**  
 Before Using Your Airbed  
 • Inflate your airbed for several hours to allow the material to stretch naturally. The material will stretch the most after you have fully inflated it.  
 • As the material stretches, you may need to add more air for firmness. Your airbed is not leaking, it is the material stretching.  
 • Add air daily at first and less after a few days to maintain desired firmness.

**⚠ WARNING**

- Not for use by children 3 years of age and younger or people with limited mobility. They may suffocate in a face down position or become trapped and suffocate in the gap between the airbed and adjacent furniture or wall. If the airbed is under inflated or deflates during use, this risk of suffocation may increase.
- Do not let young children sleep on this airbed until they are mature enough to sleep in an adult bed. Young children can suffocate on adult beds (including airbeds), particularly when sleeping with another person. Ask your pediatrician for specific recommendations for your child.
- Bed May Puncture. Do not place airbed on abrasive surfaces or in contact with sharp or protruding objects.

**\* READ AIRBED INSTRUCTION MANUAL AND FOLLOW ALL SAFETY INSTRUCTIONS TO AVOID SERIOUS INJURY OR DEATH.**

**⚠ IMPORTANT ⚠**

**Before Using Your Airbed**

- Airbed must be fully inflated prior to first use, remember to not exceed pump inflation time limit. Once inflated, allow the material to stretch on first use, this can take several hours.
- As the material stretches, you may need to add more air for firmness. Your airbed is not leaking, it is the material stretching.
- Add air daily at first and less after a few days to maintain desired firmness.

- This airbed is not for use in water. **IT IS NOT A LIFE SAVING DEVICE**. It is not a personal flotation device or water toy.
- IT IS NOT A TOY.** Do not stand, walk, jump or play on the airbed. This can result in damage or serious injury to the airbed and your health.
- Keep away from open flames, heaters and other hot objects. This airbed can melt or burn. Do not smoke on or near the airbed.

**\* ADULT SUPERVISION REQUIRED FOR INFLATION AND DEFLATION.**



flyte™ is a trademark of:  
 8th Avatar Brands Pty Ltd  
 903/50 Clarence St Sydney 2000  
[www.flytesleep.com](http://www.flytesleep.com)  
[support@flytesleep.com](mailto:support@flytesleep.com)